

Design pure, rectangular



Swing door with fixed segment and side panel

Product description

- For installation in recess and for combination with side panel or as corner entry.
- Partially framed door with one glass panel and fixed segment, opening inwards and outwards. When mounting with side panel for internal opening, the supplementary set for internal and external opening is required.
- Glazing with 6 mm single-pane safety glass according to DIN EN 12150, optionally with the easy-care HÜPPE Anti-Plaque surface finish.
- With stabilizer (inside).
- Profiles made of high-value anodised aluminium. Handle made of high-quality chrome-plated metal.
- Slopes/cut-outs possible.
- Adjustable in the wall profile 15 mm.
- Tubular hinge with continuously adjustable rise-and-fall mechanism and 5 mm lifting effect.

- Incl. HÜPPE sealing system – mounting without visible screws in the area of the wall profile.
- With drip deflector strip (height 10 mm) for optimum watertightness, or as easy-entry unit.
- Continuous magnetic strips and sealing profiles, as well as water-repellent horizontal sealing strip.
- Sealing according to DIN 14428.
- Made in Germany.
- Included in delivery: Fastening materials. Installation instructions.
- Ten-year availability guarantee on wear parts after purchase of the product.
- Handle and drip deflector strip always in high-gloss silver, except for Black Edition, White Edition.

Profile set for recess installation is required for swing doors in recess or door combined with shortened side panel.

STS: Only outwards opening. Inwards opening also possible with inwards/outwards opening supplementary set.

Slopes possible. For recess solutions, always with straight-cut profile on closing side.

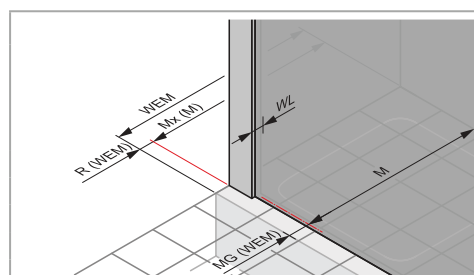
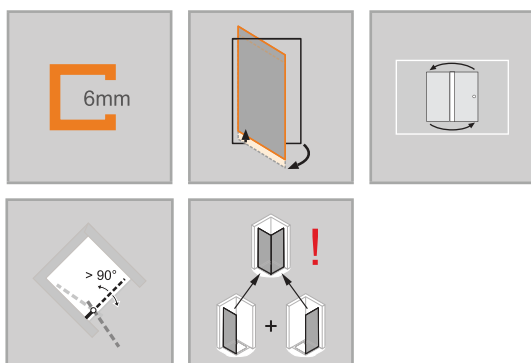

WEM = tray installation dimension (000)
M = Installation dimension middle of glass (001)
Please always specify when ordering.

Dimensions

WL:	24
R:	20
Mx:	M+10
MG:	30

Installation options 8P07

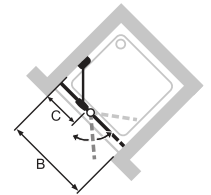
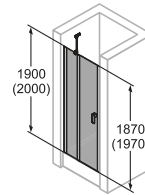

Recess = door + profile set for recess installation

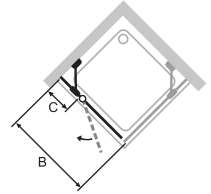
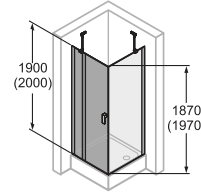

Corner solution = door + side panel

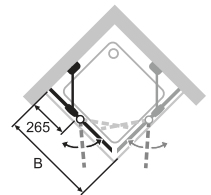
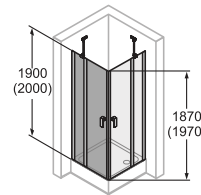

Corner entry = door + door

Min.-max. dimensions

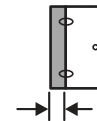

230-650

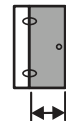

max. 900