

Entry Delay, Home Arm and Ready to Arm

This sensor supports Entry Delay, Home Arm and Ready to Arm features. Which can be adjusted in App.

Entry Delay feature : When the sensor is triggered while the system is in Arm/Home Arm status, the system will wait for preset time until the alarm goes off.

Home Arm feature : When the sensor with this feature enabled is triggered while the system is in Home Arm status, the alarm will go off.

Ready to Arm feature :

1. The system will check and show the status of doors and windows in real time in the App.
2. The App will pop up and remind you of all the unclosed doors and windows when you Arm/Home Arm the system.
3. The system will be forced to Arm/Home Arm if you are using remote controller, keypad or RFID to operate the system, and you'll also get a push notification of unclosed doors and windows.

Battery replacement instructions

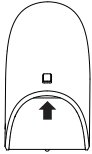

- ① Insert the flat blade of a small screw-driver into the pry-off slot of transmitter, pry up to open the back cover.

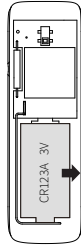

- ② Replace with 1x CR123A battery.

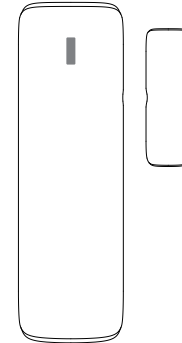

FCC Statement

This equipment has been tested and found to comply with the limits for a Class B digital device, pursuant to Part 15 of the FCC Rules. These limits are designed to provide reasonable protection against harmful interference in a residential installation. This equipment generates uses and can radiate radio frequency energy and, if not installed and used in accordance with the instructions, may cause harmful interference to radio communications. However, there is no guarantee that interference will not occur in a particular installation. If this equipment does cause harmful interference to radio or television reception, which can be determined by turning the equipment off and on, the user is encouraged to try to correct the interference by one or more of the following measures:

- Reorient or relocate the receiving antenna.
- Increase the separation between the equipment and receiver.
- Connect the equipment into an outlet on a circuit different from that to which the receiver is connected.
- Consult the dealer or an experienced radio/TV technician for help.

This device complies with part 15 of the FCC Rules. Operation is subject to the following two conditions:

- ① This device may not cause harmful interference.
- ② This device must accept any interference received, including interference that may cause undesired operation.

Changes or modifications not expressly approved by the party responsible for compliance could void the user's authority to operate the equipment.

The User Manual of Wireless Contact Sensor

Features

The wireless contact sensor is an accessory of smart alarm system. It's fashion design, RF supervision, anti-tamper protection energy saving, and low battery warning supported. The system will inform users to replace the battery in the App when needed. It's easy to setup and works well with most doors and windows. When transmitter and magnet are apart, the sensor triggers alarm.

Parameters

• Working Voltage	DC 3V
• Battery	1 × CR123A battery (3V)
• Working Current	≤100mA
• Standby Current	≤15μA
• Transmission Distance	Up to 1000m without obstacle
• Transmission Frequency	433.92MHz / 868.35MHz
• Working Temperature	-10°C-50°C
• Humidity	≤90%rh (non-condensing)
• Weight	23g(battery not included) 39g(battery included)
• Dimension	Transmitter: 84x26x22.5mm Magnet: 34x11x9.5mm (LxWxH)(±0.1mm)

Appearance

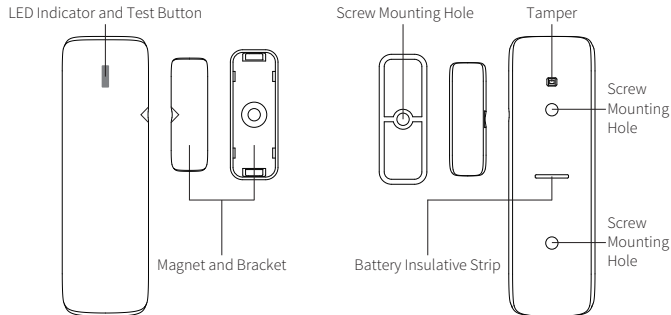

* Corresponding the triangle of the magnetic stripe to the transmitter's to get the best detection effect.

LED Indication

LED flashes once: Door/window is opened and transmitter sends signal to the main panel.
The LED indicator will light up once in 15 seconds in case of low battery. Please replace the battery in time.
Push notification will be sent to your APP.

Operating Instructions

1. Working principle

The transmitter sends trigger signal to main panel paired when the magnet is moved apart.

2. Pairing with main panel

Scanning the QR Code for Pairing.

- ① Scan the QR code on this accessory.
- ② The pairing result can be confirmed on App.

Hint: How to trigger

- ① Remove the battery insulative strip.
- ② Move the magnet around transmitter until the green LED indicator lights up.

Installation & Notice

- Pull out the battery insulative strip.
- Pairing to main panel by the App before installing.
- Attach the transmitter and magnet separately on door/window and its frame with double-side sticky tape or fix with screws. Transmitter can be put on either of magnet's left or right side.
- Make sure the distance between transmitter and magnet is less than 1cm and align horizontally.
- Avoid installing the sensors in area with a large amount of metal or electric wire.
- Corresponding the triangle of the magnetic stripe to the transmitter's to get the best detection effect.

